

PRODUCT DATA SHEET

ISO-CONNECT INSIDE EPDM

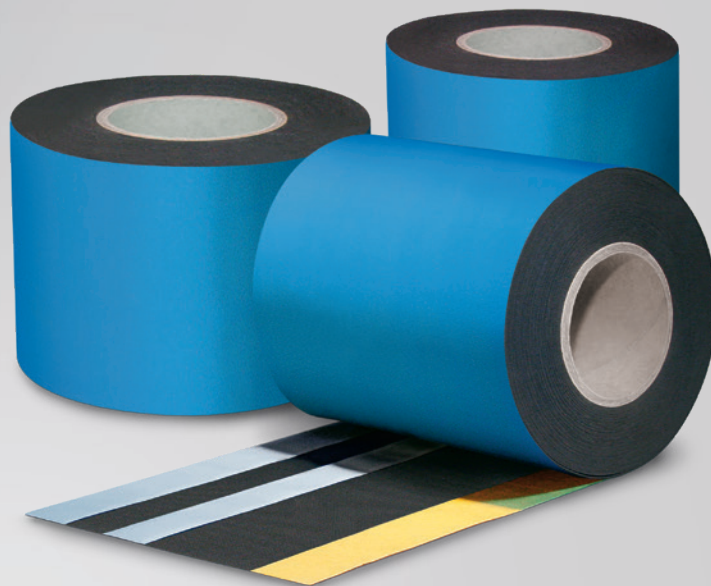

PRODUCT DESCRIPTION

ISO-CONNECT INSIDE EPDM is a butyl caoutchouc band and serves as an internal sealing on window, door and facade connections.

ISO-CONNECT INSIDE EPDM is vapour diffusion impermeable and guarantees a secure and reliable internal seal on building facade and structural connections. Joint movement is constantly compensated for through the materials high elasticity.

APPLICATION

ISO-CONNECT INSIDE EPDM is designed for a precision seal on the building's window, door and facade connections.

ISO-CONNECT INSIDE EPDM is a versatile and proven sealing band in combination with metal, window and facade constructions.

FINISHES

- Finish A: without self-adhesive
- Finish B: SK
single side self-adhesive with 1 self-adhesive strip
- Finish C: BT
single side self-adhesive with 1 or 2 butyl-adhesive strips, subject to product width
- Finish D: SK-BT
single side self-adhesive with 1 self-adhesive strip and 1 or 2 butyl-adhesive strips, subject to product width

PRODUCT ADVANTAGES

- permanent internal seal
- high elasticity – compensates joint movement
- vapour diffusion impermeable
- extreme temperature and weather resistance
- complies with the requirements of the Building Energy Act (EnEV was vaild 31.10.20) and the recommendations of the RAL "installation guide"
- 10 Year Function Warranty*

* On the conditions of the manufacturer (available on request).



ISO-CONNECT INSIDE EPDM



Technical data	Standard	Classification
Material description		synthetic caoutchouc on butyl bases
Colour		black
Building material class	DIN 13501	E
Air permeability coefficient	DIN EN 12114	airtight $\alpha \leq 0.1 \text{ m}^3/[\text{h}\cdot\text{m}\cdot(\text{daPa})^{2/3}]$
UV stability	DIN 7864 T1	UV resistant
sd-value	DIN EN ISO 12572	0.8 mm approx. 240 m 1.2 mm approx. 360 m
Water vapour diffusion resistance μ	DIN EN 1931	$\approx 300,000$
Material thickness		0.8 mm and 1.2 mm
Tensile strength	DIN 53504	$\geq 350 \%$
Elongation	DIN 53504	$\geq 8.5 \text{ mPa}$
Maximum tear resistance	DIN 53504	$\geq 20 \text{ kN/m}$
Temperature stability range		-30°C to +130°C
Handling temperature		+5°C to +35°C
Dimension tolerance	DIN 7715 T5 P3	requirements fulfilled
Storage temperature		+1°C to +25°C
Shelf life		unlimited (EPDM), finishes with adhesive strips 12 months, dry and in original packing

PREPARATION

Unroll ISO-CONNECT INSIDE EPDM sealing band and cut to the required length. The surface must be clean, dry and free from solvents, grease, dust and other anti-adhesive substances.

PROCESSING

Generating an air tight joint with the means of partial surface adhesion using gunable, paste-like and solvent free adhesive (ISO-TOP FLEX-ADHESIVE XP). Primer is not necessary with ISO-TOP FLEX-ADHESIVE XP, with the correct professional preparation.

Alternatively, finish B and D are supplied with an acrylic adhesive strip to assist attaching the end to the aluminium window until the mechanical fixings are installed, or a gunned adhesive is applied. When using finish with Butyl-adhesive, pre-treat any porous and absorbent surfaces with ISO-TOP BLUE PRIMER and then apply the self-adhesive material to the surface. For all adhesive areas use a roller to carefully apply pressure to the area until the product adopts the contours of the facade.

Butyl caoutchouc adhesives are sensitive to solvents. On complete surface bonding using solvent based contact adhesive, coat both the band and the surface and then carefully press into place.

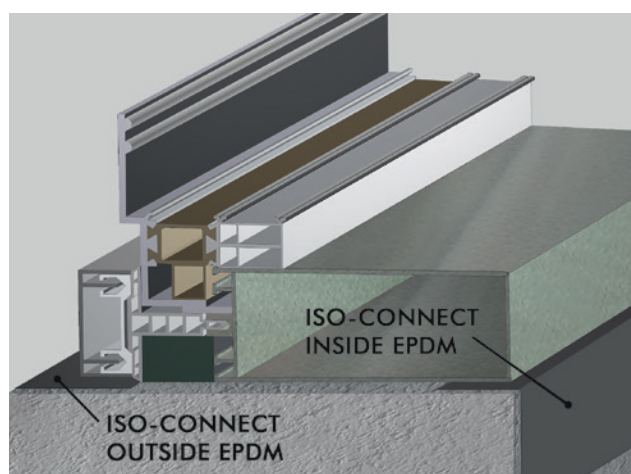

Installation example: ISO³-WINDOW SEALING SYSTEM

DIMENSIONS

width: 100, 150, 200, 250, 300, 400, 500 mm
alternative dimensions available on request

PACKAGING

rolls, roll length: 25 m